



FSOMA'S ACUPUNCTURE & EASTERN MEDICINE CONFERENCE

Westin Ft. Lauderdale Beach Resort
August 08-10th, 2025



www.fsoma.org/2025

EXHIBITOR PROSPECTUS

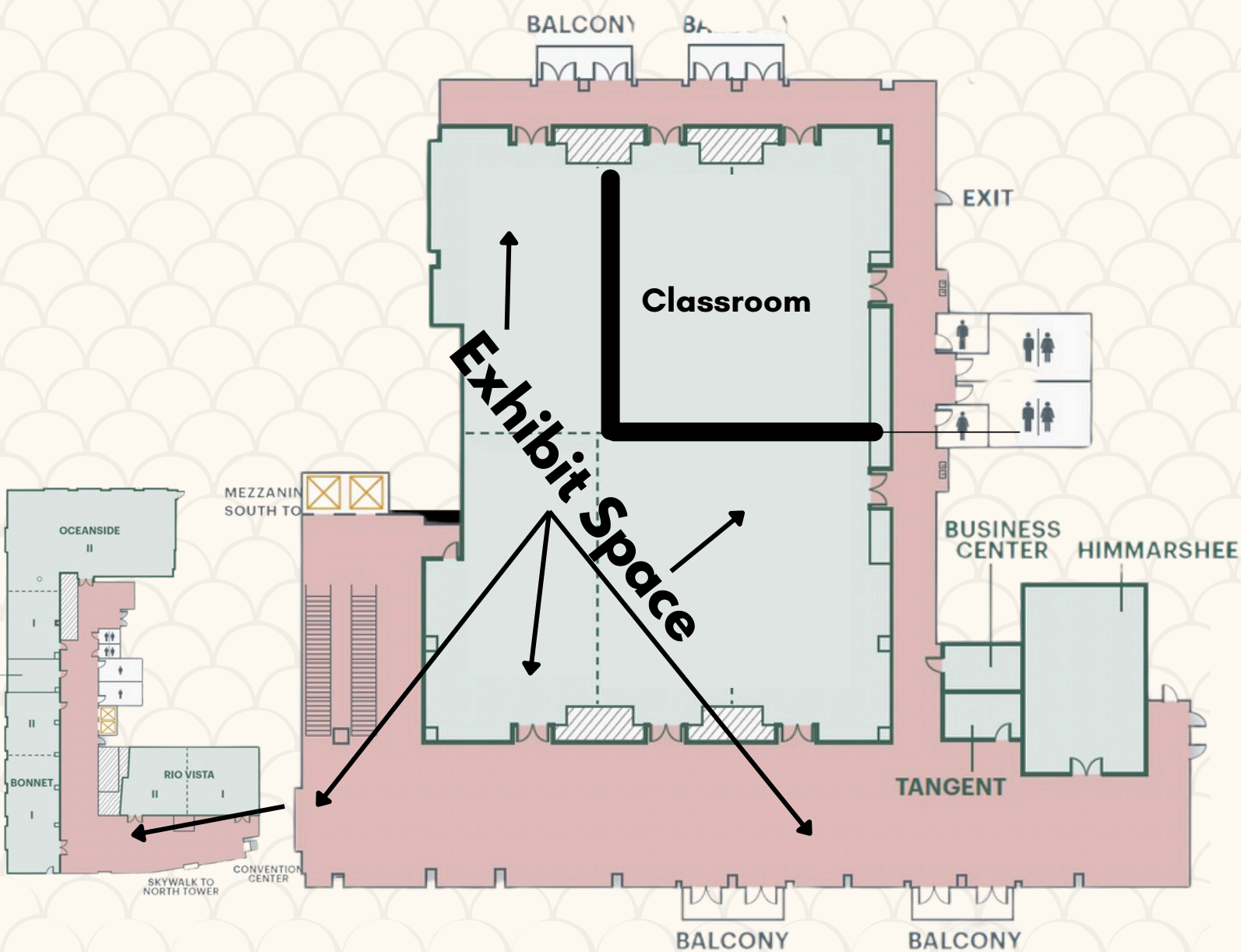

EXHIBITOR INFO

Exhibitor & Marketing Opportunities

Enjoy in-person interactions with over 200 Acupuncturists. The Acupuncture and Eastern Medicine Conference is one of the largest events on the East Coast, attracting not only, Florida Licensed Acupuncturists but others from around the country.

During this 3 day Conference, you will have the opportunity to meet and network with potential customers and build lasting professional relationships.

Statement About Exhibitors

The organizers of the 2025 FSOMA Conference encourage companies who align with the practice of Acupuncture and Eastern medicine to be a participant, get involved and register as an exhibitor.

FSOMA reserves the right to accept or deny, without cause, any application to exhibit at the conference. If there's uncertainty about how your company aligns with small businesses dedicated to Acupuncture and Eastern Medicine, the organizers recommend reaching out for clarification before registering.

[Click here to contact us](#)

The Expo Hours

Friday, August 08, 2025 - 10:15 am to 6:30 pm

Saturday, August 09 2025 - 8:00 am to 6:30 pm

Sunday, August 10, 2025 - 8:00 am to 10:45 am

The Expo will be open to non-conference attendees from the area 5:00 pm to 6:30 pm on Friday & Saturday

Set up time starts Thursday at 3pm, you must be set up and ready by 10:15am Friday Aug 8.

Breakdown is 10:45 on Sunday morning.

FSOMA will NOT use any outside housing vendors.

If you're contacted by someone to make your reservations - Don't Do It - IT IS A SCAM

[HOTEL RESERVATION](#)

Deadline for savings is on or before Monday, July 14, 2025

[SHIPPING INSTRUCTIONS](#)

[EXHIBITOR REGISTRATION](#)

[ORDER
ELECTRICITY & INTERNET](#)

*Basic shared wifi bandwidth will be available but if you need something dedicated this is where you would order it as well as electricity and other trade show items.

MORE EXHIBITOR INFO

Register to be a Conference Exhibitor | Select Your Marketing Strategy | Pick Your Exhibit Booth Placement | Network with Potential Life-Long Customers

Marketing Opportunities Available:

- **Promotional Packages:** These packages have some of the top branding available at the show. Limited spots are available, don't delay! They include a large booth.
- **Special Events & Receptions:** Exclusive to the Gold, Jade Sponsors, and Coffee sponsors only - Gain company name and brand recognition, generate "buzz" and create one-on-one time with practitioners.
- **Traffic Builders:** Put your company name and logo directly into the hands of practitioners.
- **Conference Brochure and Event Map Advertising:** Multiple sizes and options are available.
- **Silent Auction & Raffle Prizes:** Make a donation of your product or service. Silent Auction items help with fundraising for our Advocacy work. Raffle Prizes are given live during the Evening Reception on Friday and Saturday nights.
- **Exhibit Hall Booth**

CANCELLATION POLICY:

All requests for cancellation must be received by FSOMA in writing or confirmed by e-mail.

Cancellation requests prior to June 8, 2025 are eligible for a refund minus a \$75 processing fee.

Cancellation requests between June 8, 2025 and July 08, 2025 will receive a 50% refund.

Cancellations received after July 08, 2025 will not be eligible for a refund.

SPONSORSHIPS

Gold Sponsor Package: \$7,499

Saturday Evening Reception Sponsor - includes

- 5 minute speech at General Assembly
- large exhibit booth with 4 staff (Value \$1879)
- Full Page color ad in Conference Brochure. (Value \$400)
- eBlast to the entire state database.(Value \$250)
- Flyer and sample in the attendee bags. (Value \$100)
- Branding package: (Value \$499)
- Logo listing on attendee pages of the website.
- Logo listing in Event Conference Brochure / Event Map.
- Logo listing at the top of the Conference Poster

Jade Sponsor Package: \$3,499

Present a 50-minute educational Breakfast Symposium and enjoy many advertising values for your company. You'll work with the conference planning committee to select a topic to present at the Breakfast Symposium and benefit from advanced promotional design to attract the maximum number of attendees to your lecture. Breakfast Symposiums are a favorite for attendees, and are sought after by seasoned conference attendees.

Includes

- a Large Exhibit Booth with 2 staff (Value \$1,679)
- A poster outside the symposium with your company information displayed
- Full Page color ad in Conference Brochure. (Value \$400)
- eBlast to the entire state database.(Value \$250)
- Flyer and sample in the attendee bags. (Value \$100)
- Branding package:
- Logo listing on attendee pages of the website.
- Logo listing in Event Conference Brochure / Event Map.
- Logo listing 4th down the Conference Poster

Choose from Friday, Saturday, or Sunday 7:30 am to 8:30 am Breakfast Symposium (first come first serve) Symposium space allows for up to 100 attendees. Additional attendee space can be added with additional funding.

**Note: Symposiums can be related to your products and business. Clinically useful classes are more popular as they are eligible for CEUs & PDAs.*

MORE SPONSORSHIPS

Friday Reception Sponsor Package - \$2,699

- Includes a Large Exhibit Booth with 2 staff (Value \$1,679)
- A Poster of your design, displayed during the Friday reception.
- Full Page color ad in Conference Brochure. (Value \$400)
- eBlast to the entire state database.(Value \$250)
- Flyer and sample in the attendee bags. (Value \$100)
- Branding package:
 - Logo listing on attendee pages of the website.
 - Logo listing in Event Conference Brochure / Event Map.
 - Logo listing 4th down the Conference Poster.

Coffee Break Sponsor Package - \$2,129

- Includes a Large Exhibit Booth (Value \$1,679)
- A Poster of your design, displayed during the breaks.
 - Break times are scheduled
 - You pick the break you wish to sponsor: Friday 10:15 am, Friday 3:15 pm, Saturday 10:15 am, Saturday 3:15 pm, Sunday 10:15 am
- Full Page color ad in Conference Brochure. (Value \$400)
- eBlast to the entire state database.(Value \$250)
- Flyer and sample in the attendee bags. (Value \$100)

TRAFFIC BUILDING ADD ONS

Display Poster: \$395

Exclusive | Only 1 available

- 1 Display Poster Stand (Size: 36" x 24") Limited - Available on a first-come, first-served basis.
- If a Research Posters it should be 48" wide x 36" tall
- You supply the graphics for the poster.
- The poster will be displayed near the front of the Registration Desk, posted on the Conference website, and as an addition to the printed Conference Brochure.
- Your Brand's participation will be mentioned in the promotional email to pre-registered attendees via FSOMA.org (FSOMA.org is the leading online resource for Florida's Acupuncture and Eastern Medical Professionals).

MORE TRAFFIC BUILDING ADD ONS

Notepad Sponsor: \$295

Exclusive | Only 1 available

Attendees know that one of the best ways to stay focused and organized is to take good notes. Whether attendees are in the classroom or walking the Expo, they all need a handy place to make notations, organize business cards, keep track of orders, and remember show deals.

Use this sponsorship opportunity to make a statement by printing your business name and logo on the Notepad, which all attendees will reach for many times throughout the Conference.

- The Sponsor is responsible for **selecting and providing** at least 250 notepads with approved artwork printed on them.
- Notepads will be added to each Attendee's welcome bag.
- Notepads must be delivered to the Hotel before the Conference start date, to be included in the welcome bag.
- For help or any questions, please contact Ellen Teeter, FSOMA Executive Director.

Lanyards: \$295

Exclusive | Only 1 available

- Company name only - exhibitor provides lanyards and badge holders.
- Distributed at Attendee Registration Table.

Water Bottles: \$295

Exclusive | Only 1 available

- Company to provide reusable water bottles with their company logo on it.
- Reusable water bottles will be added to the Attendee Welcome Bag.



Attendee Bag Inserts

- Single Insert: Trifold Brochure/Flyer - \$150
- Single Insert: Sample with brochure - \$100
- Company Catalogue insert - \$300
- Distributed in Attendees Welcome Bags



MORE TRAFFIC BUILDING IDEAS



Attendee Bags: \$595

SOLD OUT

- Company provides the logo and the bags.
- Company name or logo should be placed on one side of the attendee welcome bag.
- FSOMA Conference logo on one side of the bag.

Get Extra Attention with an Email Blast: \$250

- Blast out an Email to the 2025 Pre-Registration Attendees **and** the entire FL Licensed Acupuncturists database.
- Advertise your show special.
- Introduce new products or a featured one.

FULL COLOR CONFERENCE BROCHURE & EVENT MAP MARKETING OPPORTUNITIES

Printed Conference Brochure Ads *

***Early Bird Special * Full Page Ad for Early Bird Exhibitors for only \$400.**

Ad Size Options:

- Full Page \$500
- Half Page \$330
- Quarter Page \$220

FULL-COLOR Conference Registration Brochure.

The deadline to submit an ad copy is June 1, 2025.

EXHIBIT HALL BOOTH OPPORTUNITIES

Large Booth: \$1,699 *

- The exhibit booth space is 10' wide and 8' deep, allowing a height of 10' x 10' for backdrop displays.
- Ideal for Exhibitors with large pop-up displays behind their table, and who require electricity.
- Located against a wall either in Exhibit Hall or if you prefer in the Foyer.
- 2 Exhibitor Passports
 - If your company anticipates sending additional staff or other individuals to the conference, then your company will be required to purchase additional admission passes to the Exhibit Hall - at a cost of \$100 each.
- The difference is in floor space and exhibit height, not actual table size - All Exhibits, regardless of size are provided complimentary a 6' table, linen, wastebasket, and two chairs

Small Booth: \$1,399*

- These spaces are 7' wide x 5' deep.
- Booth Space: 6 inches on each side of the 6-foot table with 2.5' to stand in front or behind the table.
- 1 exhibitor passport.
 - Additional Staff Pass may be purchased if needed- at a cost of \$100 each.
- The difference is in floor space and exhibit height, not actual table size - All Exhibits, regardless of size are provided complimentary a 6' table, linen, wastebasket, and chair

Additional Company Representatives - \$150

- Large Booths come with 2 Company Representative passports.
- Small Tabletops come with 1 Company Representative passport.

If you need more representatives for your company add them during your exhibitor registration.

****FSOMA Business Members save 20%***

Las Vegas Ballroom & Prefunction



Exhibits 49, 50, 51 in Rio Vista Foyer

See Next Page

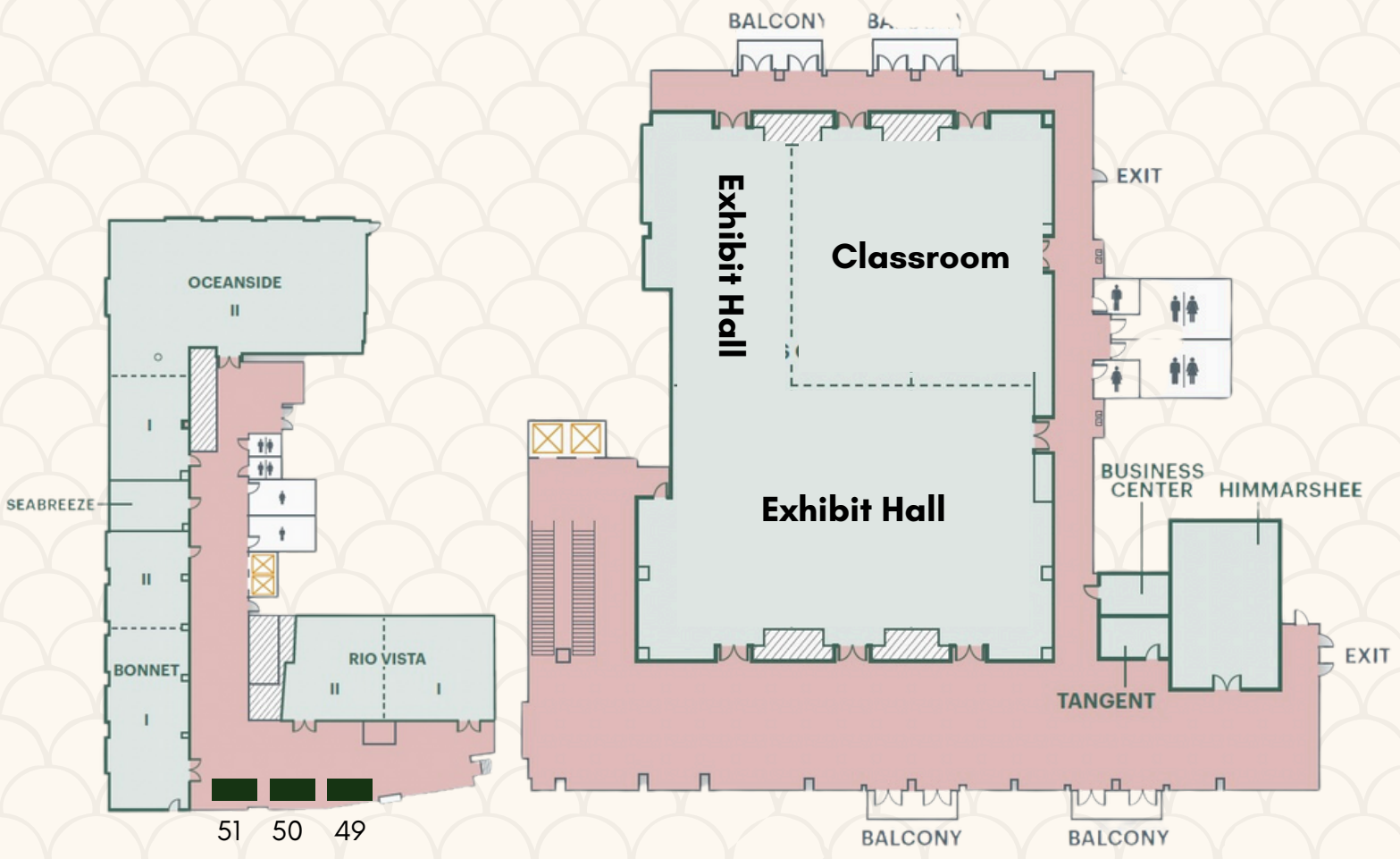

Silent Auction Donation & Raffle Items

Anyone can participate in these extra-value events.

Silent Auction:

During the breaks and receptions attendees bid on the FSOMA Silent Auction. It is our biggest fundraising campaign for the Forward Fund, a fund organized to help pay for advocacy initiatives such as the Acupuncture Education Day (the annual health fair at the Florida State Capitol) and exhibiting at other medical conferences throughout the year.

Get extra attention during the bidding by donating a gift item.

Donation Suggestions:

- A sample basket of your products
- A training program/CEU class
- A vacation
- iPad or other technology with your logo and information prominently displayed

Your donation towards the Silent Auction will help us raise the funds we need to continue our Advocacy work.

Tell us about your donation

Raffle Donations:

Your Raffle Items will be given out to our attendees during our Evening Networking Reception held on Friday and Saturday nights. You keep the raffle items at your booth and we announce winners and send them to your booth to collect your prizes.

Raffle Items could be:

- a box of needles
- a bottle of herbs
- a gift certificate towards product or free shipping
- anything that helps them remember you.

Our evening receptions are well attended by conference attendees, exhibitors, speakers, and guests.